

30'-11" [9.4m] ZONING HEIGHT
 29'-3" [8.9m] STRUCTURE'S HEIGHT

HEIGHT OF BUILDING: 351.3"

232.0" SECOND FLOOR CEILING
 215.0" TOP OF WINDOWS

8'-1" [2.5m] FLOOR HEIGHT
 1'-0" [0.3m] EST. JOIST

135.0" SECOND FLOOR
 123.0" FIRST FLOOR CEILING
 114.0" FIRST FLOOR SOFFIT

9'-1" [2.8m] FLOOR HEIGHT
 1'-2" [0.4m] EST. JOIST

94.0" TOP OF DOORS

14.0" 157.15 FIRST FLOOR

0.0" TOP OF FOUNDATION WALL
 -8.0" MAX EXTERIOR GRADE

156.30 Established Grade

7'-8" [2.3m] FLOOR HEIGHT
 8'-4" [2.5m] U/S FOOTING
 7'-10" [2.4m] WALL HEIGHT

-91.0" BASEMENT SLAB
 -100.0" U/S OF FOOTINGS

SB12 HEEL HEIGHT CHECK
 Overhang 16" Pitch 23.97
 Wall 8'-1" Soffit drop 8.00"

STAIR CALCULATION
 16 Risers @ 0'-7 5/8" each
 For a total run of 121.00"

MAX RISE FOR STAIR IS 7" (Max. straight run is 17 risers)

STAIR CALCULATION
 15 Risers @ 0'-7" each
 For a total run of 105.00"

MAX RISE FOR STAIR IS 7" (Max. straight run is 17 risers)

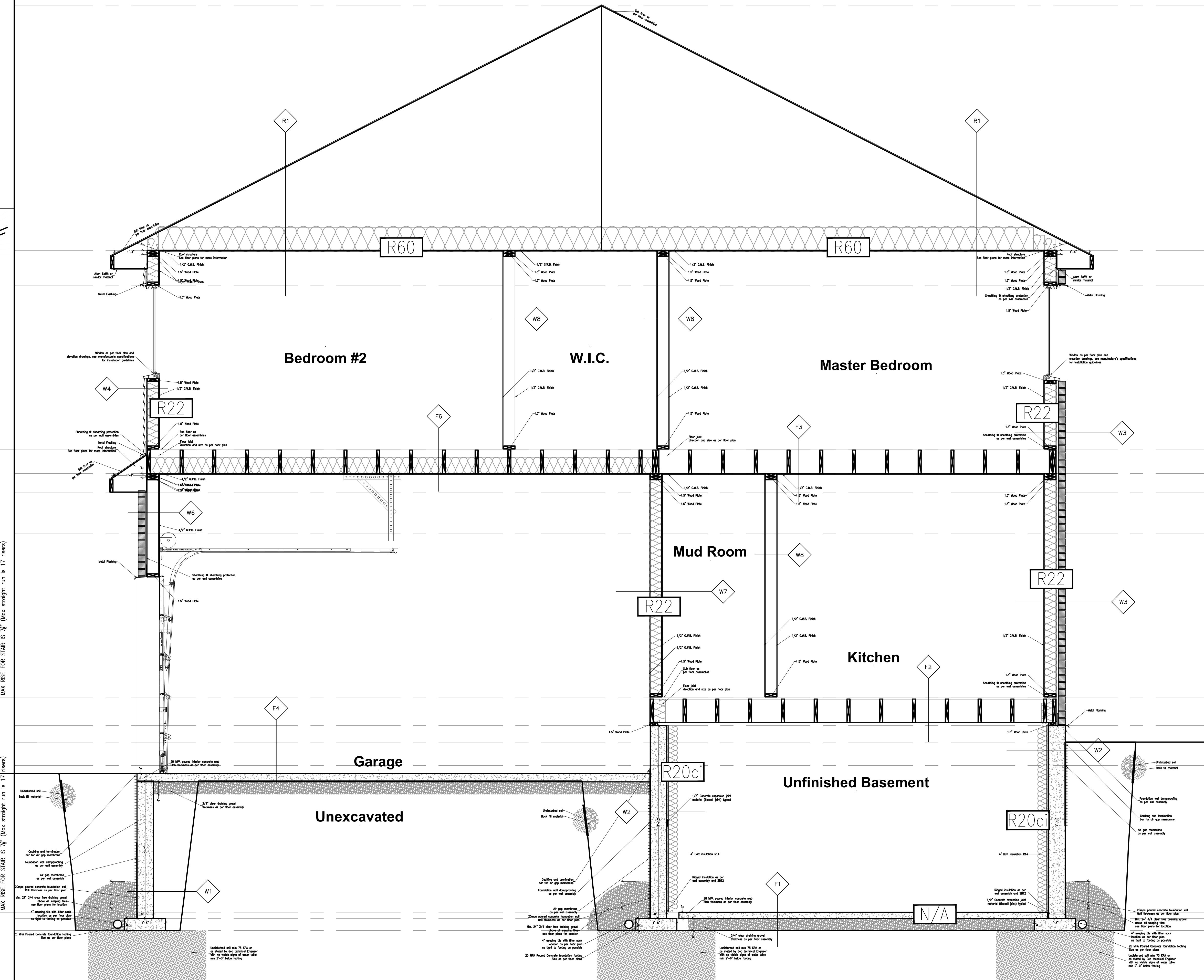

S1 Section
 V01 SCALE 1/2" = 1'-0"

PROJECT: Stonehaven Plan 1b, Burlington Ontario

VIRTUAL CREATIONS INC. PROJECT No: 28844
 (905) 481 1153 BCIN No. 28844

Client: Dawn Victoria Homes Classification:
 Original Signature:
 WWW.VCINC.CA

ERIC CANTON BCIN#25135

AT VIRTUAL CREATIONS INC. THE BEST EFFORT HAS BEEN MADE TO RECORD EXISTING BUILDING STRUCTURES AND PROPOSED A COMPREHENSIVE SET OF CONSTRUCTION DRAWINGS. HOWEVER, THERE ARE AREAS AT THE TIME OF DESIGNING THAT ARE UNAVAILABLE OR INACCESSIBLE. WITH PROPER COORDINATION ELEMENTS SUCH AS ROOF TRUSSES AND ENGINEERED FLOOR JOIST TO VIRTUAL CREATIONS INC. TO REVIEW PRIOR TO FABRICATION. DETERMINE LOCATIONS OF EXISTING SERVICES IN FORM VIRTUAL CREATIONS INC. OF ANY CHANGES, DISCREPANCIES OR SUBSTITUTIONS FOR REVIEW BEFORE COMMENCING CONSTRUCTION. ALL DESIGNS AND DRAWINGS ARE THE SOLE PROPERTY AND COPYRIGHT OF VIRTUAL CREATIONS INC. ANY REPRODUCTIONS MUST BE AUTHORIZED BY VIRTUAL CREATIONS INC. OR PURCHASED THROUGH VIRTUAL CREATIONS INC. DIRECTLY.

ISSUED: 04.21.2021